







-  13.2m x 4.8m
-  Floor Area 63m²
-  1 Bedroom
-  1 Bathroom
-  1 Toilet

KENDALL

This stunning small home is designed to suit the narrowest of sections and is available in a mono, gable or hip roofline. It's a great option for a bach by the sea, airbnb rental investment, a town house or granny flat in an urban area.

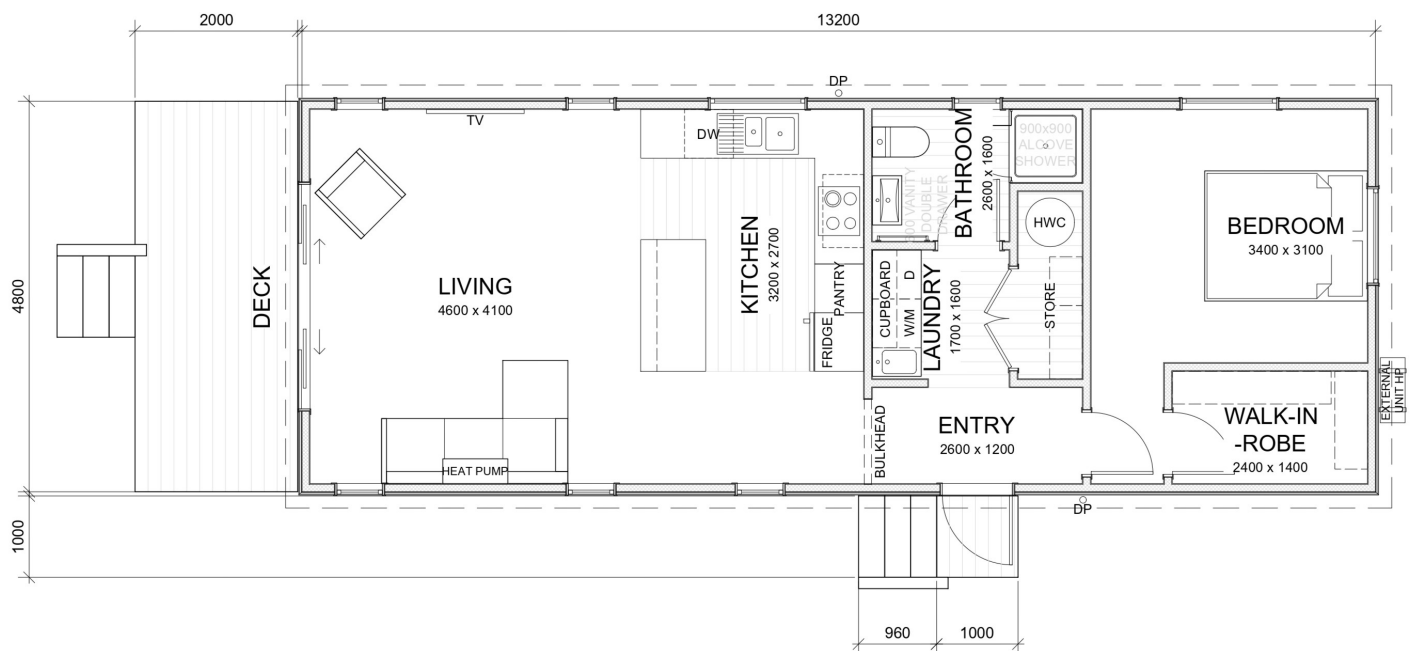

(Images are artist impressions only & the landscaping is not included. This plan is available as a mono, gable or hip roofline. We can add or remove wing walls & adjust the cladding to suit your style. Plans are subject to change.)



SOUTH PEAK HOMES
from our place to your space