

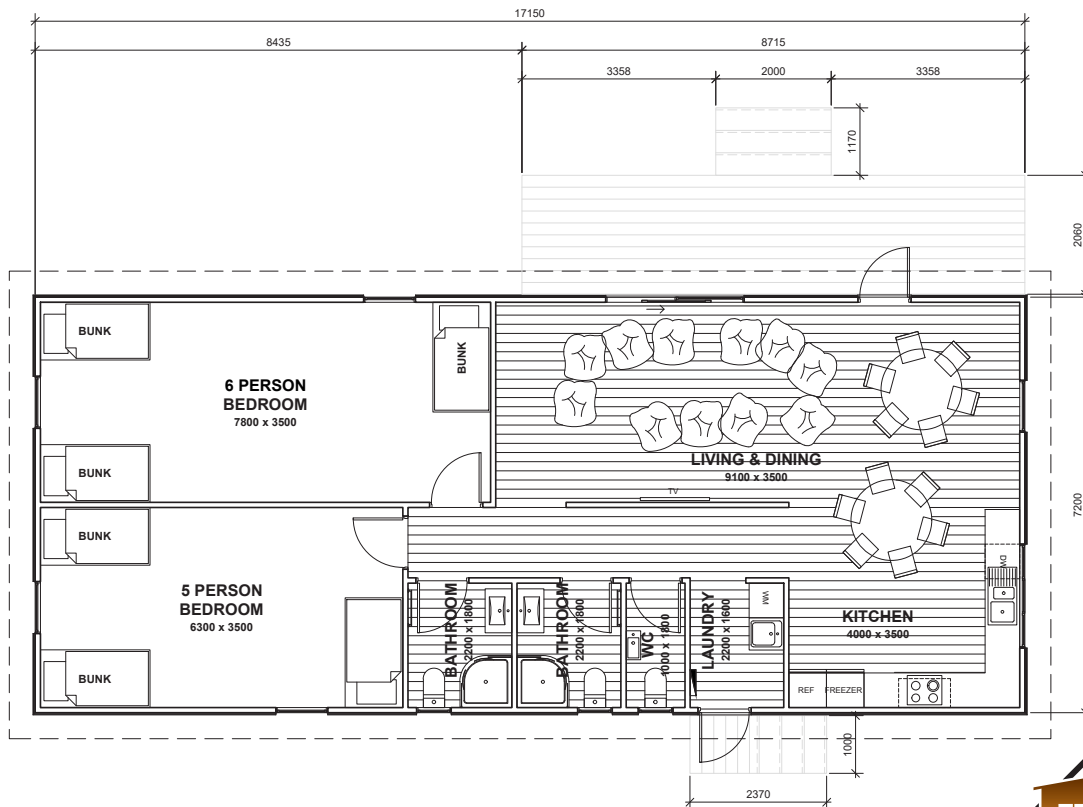

WHITCOMBE.11

- ± 17.15m x 7.2m
- ⊠ Floor Area 123m²
- 🛏 11 Beds
- 🚿 2 Bathrooms
- 🚽 3 Toilets

This is a great option for a self contained, all in one accommodation unit for up to 11 people and features 2 bunk rooms, a full bathroom, a large open plan kitchen, lounge, dining area and a laundry. At 7.2m wide x 17.15m long this unit will accommodate a large number of staff members or guests very comfortably, with plenty of living and socializing space.



SOUTH PEAK HOMES
from our place to your space

(Images are artist impressions only & the landscaping is not included. This plan is available as a mono, gable or hip roofline. We can add or remove wing walls & adjust the cladding to suit your style. Plans are subject to change.)