

WHITCOMBE.9

- ↕ 14.64m x 7.2m
- ⊞ Floor Area 106m²
- 🛏 9 Beds
- 🚿 2 Bathrooms
- 🚽 2 Toilets

This is a great option for a self contained, all in one accommodation unit for up to 9 people and features 2 bunk rooms, 2 full bathrooms, a large open plan kitchen, lounge, dining area and a laundry. At 7.2m wide x 14.64m long this unit will accommodate a medium number of staff members or guests very comfortably, with plenty of living and socializing space.

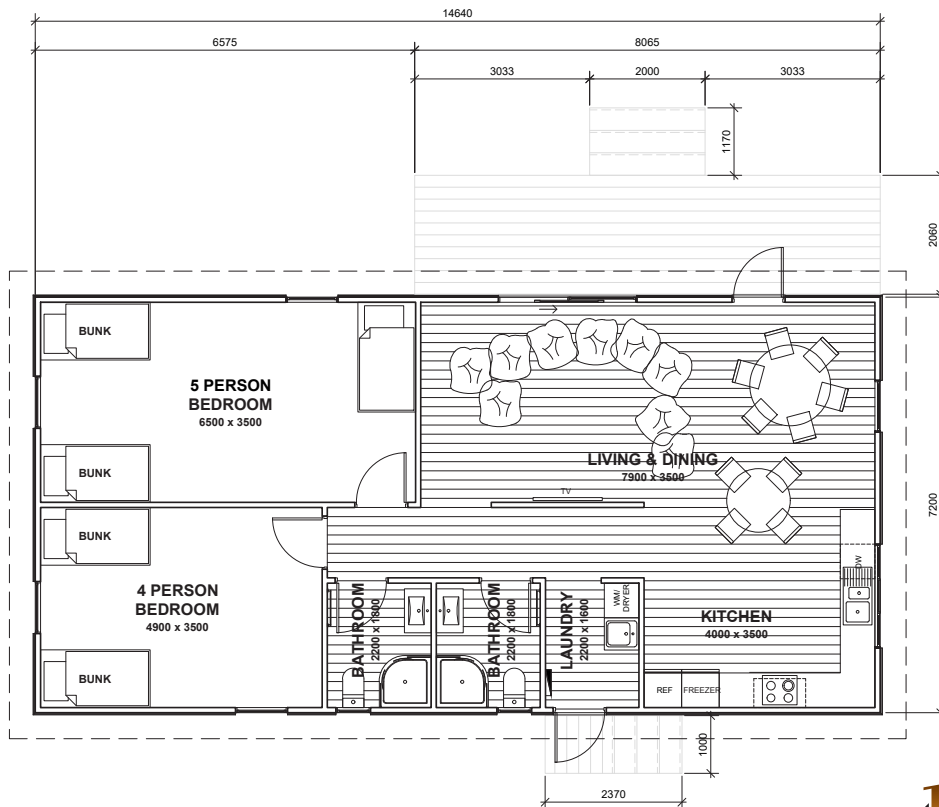

(Images are artist impressions only & the landscaping is not included. This plan is available as a mono, gable or hip roofline. We can add or remove wing walls & adjust the cladding to suit your style. Plans are subject to change.)



SOUTH PEAK HOMES
from our place to your space