

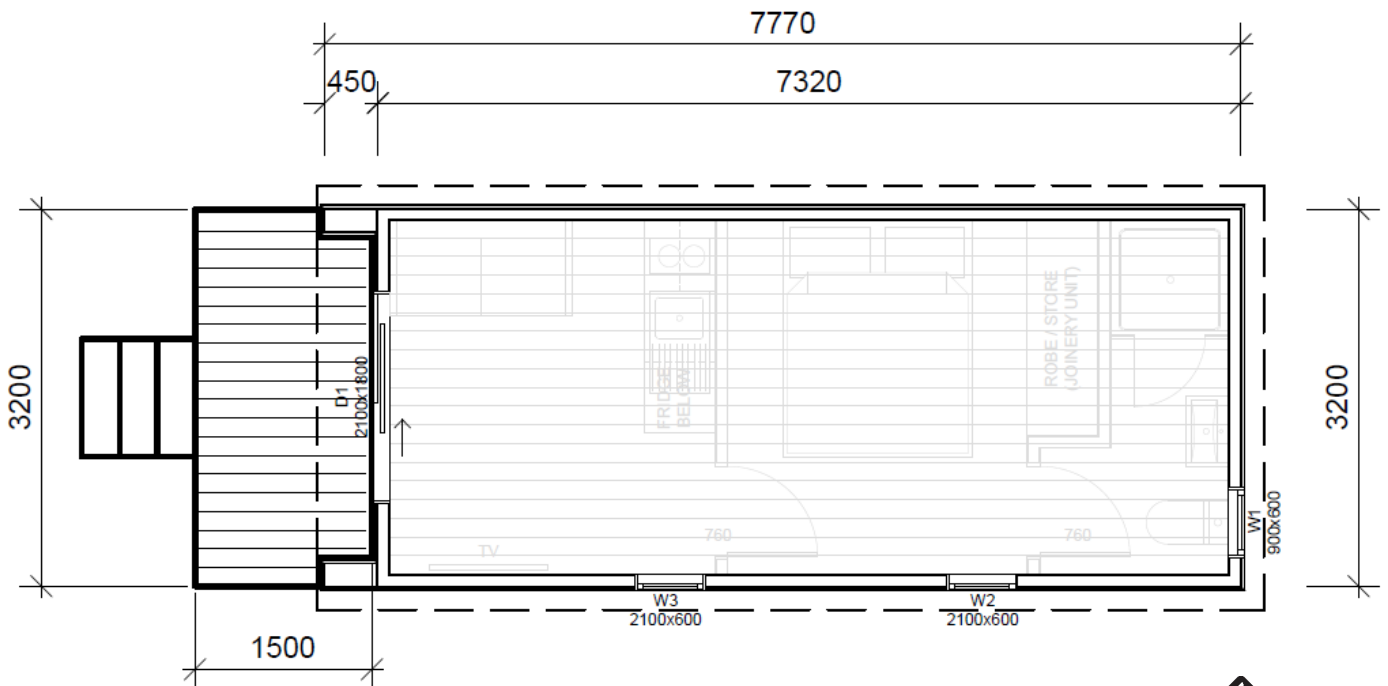

- ↕ 7.32m x 3.2m
- ⊠ Floor Area 23.4m<sup>2</sup>
- 🛏 1 Bedroom
- 🚿 1 Bathroom
- 🚽 1 Toilet

## HUTT 3

If you're needing a new 1 bedroom home, office, studio, sleepout, guest or staff accommodation, a granny flat or multi-unit holiday park accommodation, this is a great option for you! Available with or without a kitchen, bathroom, wardrobe & the option of an extended roof as a veranda.



(Images are artist impressions only & the landscaping is not included. This plan is available as a mono or gable roofline. We can add or remove wing walls & adjust the cladding to suit your style. Plans are subject to change.)



**SOUTH PEAK HOMES**  
from our place to your space