







-  9.2m x 3.2m
-  Floor Area 29.4m²
-  1 Bedroom
-  1 Bathroom
-  1 Toilet

HUTT 4

If you're needing a new 1 bedroom home, office, studio, sleepout, guest or staff accommodation, a granny flat or multi-unit holiday park accommodation, this is a great option for you! Available with or without a kitchen, bathroom, wardrobe & the option of an extended roof as a veranda.

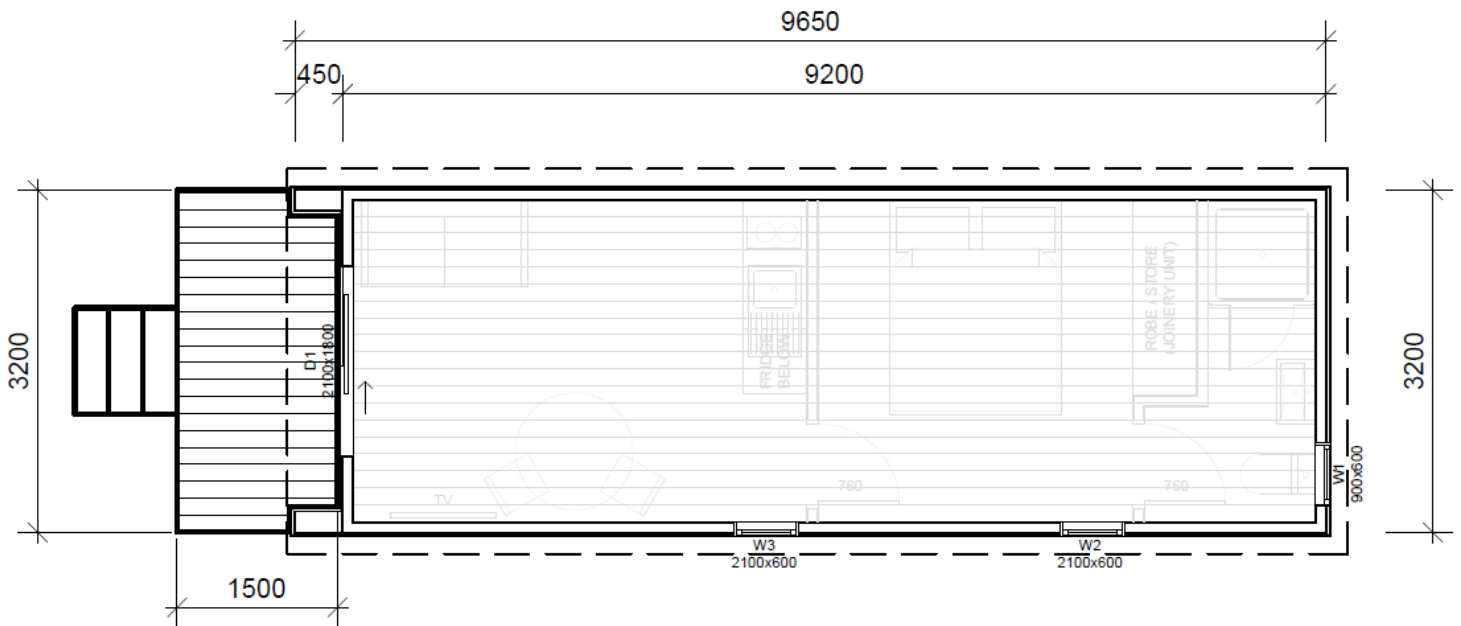

(Images are artist impressions only & the landscaping is not included. This plan is available as a mono or gable roofline. We can add or remove wing walls & adjust the cladding to suit your style. Plans are subject to change.)



SOUTH PEAK HOMES
from our place to your space